



Panic Exit Devices



"Safety in your hands"

NINZ® panic exit devices are certified CE in accordance with EN 1125:2008. The perfect union of technical application and elegant simplicity.

NINZ® Panic exit devices

PROVISIONS/REGULATIONS	3 - 5
EXUS	6 - 11
EXUS FOR GLAZED DOORS	12 - 13
TWIST	14 - 17
SLASH	18 - 23
GENERAL INFORMATION	24
OPTIONAL VARIATIONS	25
DRAWINGS OF ENCUMBRANCES	26 - 28

NOTE

All rights reserved. Full or partial reproduction forbidden without prior authorization from NINZ®S.p.A. The company reserves the right to make product modifications. All measurements are provided in millimeters (mm). Technical changes can be made to all contents of the present brochure without prior notice.

Due to limitations inherent to the printing process, the colors depicted in this catalog are for illustrational purposes only.

EXUS® *Twist* SLASH

- Certified C € in accordance with EN 1125:2008
- Functions with insertable latch mechanism
- Ideal for use on fire/smoke doors up to class EI₂120 and REI 120
- For single-leaf doors; for the active and passive leaves of double-leaf doors
- For door sizes fitted to wall spaces up to 1350 x 2880 mm
- For doors weighing up to 300 kg
- Durability tested for 200,000 open/close cycles
- Tested for temperatures from -10°C to +60°C
- KIT includes every element approved in the initial test

REGULATION EN 1125:2008

New European standard for panic exit devices with **CE** marking, in effect since 01.01.2010 as a replacement for the previous standard EN 1125:1997 + A1:2001.

The standard specifies requirements for manufacturing, performance and testing for panic exit devices activated mechanically by means of horizontal bars and designed specifically for use during panic situations along escape routes.

The **CE** conformity to standard requirements must be demonstrated through initial testing of panic exit devices by type and through manufacturer testing that is overseen by the certifying body.

Performance and safety requirements

- Device selection is based on risk analysis of its prospective use as prescribed for doors installed along escape routes;
- The only devices that are acceptable for panic exits are those that comply with regulation EN 1125 and enable exit at any time by means of a single activation of the horizontal bar. Use of the device must require no prior knowledge of its functioning method and opening must occur even when the door is subject to a load. These requirements simulate the actual forces that are likely to be applied by people in a state of panic;
- Panic exit devices must be designed so that it takes less than 1 second to open the door from the inside at any time;
- The materials used to manufacture panic exit devices must permit functioning at temperatures between -10°C and + 60°C;
- **The only way to confirm the suitability for use on fire/smoke doors is by passing a fire resistance test conducted on both sides of the door in conformity with EN 1634-1;**
- **It is extremely important not to use panic exit devices on fire door systems with higher fire resistance than has been verified for the device itself;**
- Visual inspection and measurements with appropriate calipers have been prescribed to reduce the risk of entrapment of fingers and/or device blockage;
- Proturbances and corners that could result in personal injury must be smoothed and rounded;
- Panic exit devices that activate upper and lower vertical rods (for passive leaves, for example) must ensure that manipulation of the lower rod does not activate the upper rod;
- Counterstrikes installed above floor level must rise no higher than 15 mm and must be tapered in the direction of the escape route;
- Periodic lubrication must be possible without requiring disassembly;
- Application on doors weighing more than 200 kg and with door leaves larger than 1320 x 2520 mm in size requires additional testing under more severe conditions;
- The durability of panic exit devices is classified as grade 6 (100,000 cycles) and grade 7 (200,000 cycles). For passive leaves, grade 6 corresponds to 10,000 cycles and grade 7 to 20,000 cycles;
- The presence of an external control (key, cylinder, lever handle, doorknob, etc.) must not in any way impede activation of the panic exit device from the inside;

- **Only the external controls designated by the manufacturer of the panic exit device are considered to comply with the standard;**
- External controls designated by the device manufacturer may be activated manually or electrically (e.g., remotely controlled or latch mechanism with electric handle activation);
- The materials used to manufacture the panic exit device must not contain or release toxic substance in excess of the limits prescribed by European and national regulations;
- Panic exit devices must be accompanied by clear and detailed installation and maintenance instructions that include a list of all components tested and approved for use with the device and that could be acquired separately;
- **It is essential that the installation of panic exit devices follows manufacturer instructions and employs duly compatible components only;**
- The horizontal bar is usually installed at a height range of 900 to 1100 mm from the finished floor level with the door in the closed position. When the majority of building users are known to be children, a lower bar height should be considered;
- Once the device has been installed, the instructions are handed over to the user, who should keep them on file for reference during maintenance operations;
- **To ensure that actual performance conforms to certification, regular maintenance checks need to be carried out on a monthly basis (minimum) in order to ensure that all system components continue to correspond to the list of components handed over after installment.**

OFFICIAL JOURNAL OF THE EUROPEAN UNION 4 MARCH 2009



Information from member states:

communication of the Commission in the context of the application of directive 89/106/CEE of the Council related to the harmonization of legislative, regulatory and administrative provisions of Member States in relation to construction products.

OEN (1)	Reference and title of the regulation	Reference of the repl. standard
	EN 1125:2008 Door and window accessories.	
CEN	Panic exit devices for emergency exits activated by a horizontal bar - Requirements and test methods	EN 1125/1997
Date of entry into effect of the standard as a harmonized European standard		Expiration date of the co-existence phase
01.01.2009		01.01.2010

CE MARKING IN ACCORDANCE WITH EN 1125 : 2008

How to read the CE marking:

										The CE conformity marking consists of the  symbol indicated in Directive 93/68/CE																													
EXUS panic exit device										Product description																													
Ninz S.p.A. Corso Trento, 2/A I-38061 ALA (TN)/ITALIA										Name or identification mark and registered address																													
08										Last two digits of the year when it was applied																													
EN 1125:2008										Number of the standard																													
0425										Identification number of the certifying body																													
1228-CPD-2007										CE certification number																													
<table><tr><td>3</td><td>7</td><td>7</td><td>B</td><td>1</td><td>3</td><td>2</td><td>1</td><td>A</td><td>A</td></tr><tr><td>1°</td><td>2°</td><td>3°</td><td>4°</td><td>5°</td><td>6°</td><td>7°</td><td>8°</td><td>9°</td><td>10°</td></tr></table>										3	7	7	B	1	3	2	1	A	A	1°	2°	3°	4°	5°	6°	7°	8°	9°	10°	Product classification									
3	7	7	B	1	3	2	1	A	A																														
1°	2°	3°	4°	5°	6°	7°	8°	9°	10°																														

CLASSIFICATION IN ACCORDANCE WITH EN 1125:2008

Interpreting the classification:

Use category (1st character)

A single grade of use is allowed:

- grade 3: high frequency use and easy to use, in the sense that an accident or improper use is highly unlikely.

Durability (2nd character)

Two grades of durability are permissible:

- grade 6: 100,000 test cycles;
- grade 7: 200,000 test cycles.

Door mass (3rd character)

There are three different grades of door mass:

- grade 5: up to 100 kg;
- grade 6: up to 200 kg;
- grade 7: over 200 kg.

Suitability for use on fire/smoke doors (4th character)

There are three different grades:

- grade 0: not approved for use on fire/smoke doors;
- grade A: suitable for use on smoke doors;
- grade B: suitable for use on fire/smoke doors on the basis of EN 1634-1 conformity testing.

Personal safety (5th character)

A single grade of personal safety is allowable:

- grade 1: all panic exit devices must guarantee personal safety, and only the maximum grade is acceptable for the present standard.

Corrosion resistance (6th character)

The two grades of corrosion resistance specified in EN 1670:2007 are allowable:

- grade 3: 96 h (high resistance);
- grade 4: 240 h (extremely high resistance).

Material safety (7th character)

A single grade of material safety is allowable:

- grade 2: due to the fact that material safety must be considered secondary to personal safety, the minimum grade represents the only category allowed.

Protrusion of the horizontal bar (8th character)

Two degrees of horizontal bar protrusion are allowed:

- grade 1: protrusion up to 150 mm (extended protrusion);
- grade 2: protrusion up to 100 mm (standard protrusion).

Horizontal bar activation type (9th character)

Two types of activation are allowed:

- type A: panic exit devices with push bar activation (examples: EXUS, TWIST);
- type B: panic exit devices with touch bar activation (example: SLASH).

Field of door application (10th character)

The three allowable categories of field-of-door application are associated with the end use of the panic exit device:

- category A: single-leaf doors, double-leaf doors: active or passive leaf;
- category B: single-leaf doors;
- category C: double-leaf doors, the passive leaf only.

TESTING FACILITIES

Our company applies its own system tests and experimentation to ensure maximum quality, reliability and innovation for serving our clients.



Company furnace



Mechanical testing systems



Operational testing systems



PRESENTATION

EXUS® panic exit devices

Ongoing research by Ninz S.p.A., leader in fire doors, has once again proven the company's forward-looking capacity to offer products with a strong identity in terms of design and technology, such as its new series of EXUS® panic exit devices.

EXUS® exit devices are **CE** certified in accordance with European standard UNI EN 1125:2008, which entered into effect on the 1st of January 2010, and includes a series of significant innovations that broadens the requirements for maximum safety and ease of opening.

The KIT to fit your needs

The entire series of EXUS® exit devices is proposed in elegant and functional KITS in the most suitable configuration for distributors.

KIT-based packaging ensures that clients, installers and end users alike receive complete panic exit systems for which all parts are fully and safely **CE** certified in every respect.

Finishing

Attention to detail and proportions are highlighted by carefully selected materials and finishing.

In addition to **black NYLON** with an **anodized ALUMINIUM** bar, new combinations are now available, like the all **polished STAINLESS STEEL**, or **polished chromium-plated ALUMINIUM** version with the **anodized ALUMINIUM** bar. Many other combinations of colors and surfaces are available for equally aesthetic solutions.

The particular aesthetic of softer forms is one of the exclusive advantages of EXUS® panic exit devices and represents the fruit of cooperative efforts with Studio MM Design, which has been collaborating with the company for many years.

Certifications and spare parts

Given the importance of maintaining **CE** certification for the entire system, spare parts have been dedicated special attention because of the essential role they play within an overall system tested in accordance with regulation UNI EN 1125:2008.

Only **original NINZ replacement parts**, therefore, can ensure that the product maintains the same characteristics over time.

This is why the instructions for the EXUS® panic exit device also include, in addition to the installation and maintenance instructions, an exploded drawing that identifies every smallest detail of the certified system and all the necessary references for ordering replacement parts.

With the new EXUS® panic exit devices, NINZ S.p.A. demonstrates the company's willingness to develop its market by investing in projects and business image in order to add value to its own products while maintaining highly competitive quality-price ratios.



Black NYLON handle

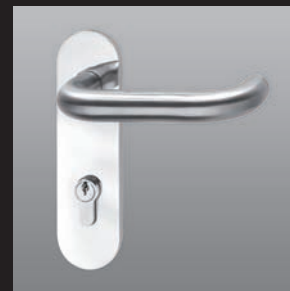

ALUMINIUM handle with
STAINLESS STEEL lever and
chromium-plated ALUMINIUM
plate



Polished STAINLESS STEEL handle

NOTE

In this series, the external controls have the same finishing as the exit device.

EXUS® - Characteristics, certifications

Panic exit device

NINZ
FIREDOORS

CHARACTERISTICS

- New design and an avant garde conception of technology;
- Available in different color and surface combinations: polished stainless steel lever arms and bar, aluminium with lever arms in a polished chromium-plated finish and an anodized aluminium bar, or the ever-fashionable classic combination of black nylon lever arms with an anodized aluminium bar;
- Certified for insertable latch mechanisms with 40 or 65 mm holes for single or active leaves, with 30 or 80 mm openings for passive leaves and panel rotation up to 45°;
- Key locking also possible from the exit bar side;
- Reversible for right- or left-handed opening;
- Protrusion 125 mm;
- Proposed in complete KIT in a single black/yellow box;
- Package label identifies product characteristics;
- Wide variety of options: colored bars, colored or stainless steel handles, latch mechanisms with access control devices, special coded or mastered cylinders.

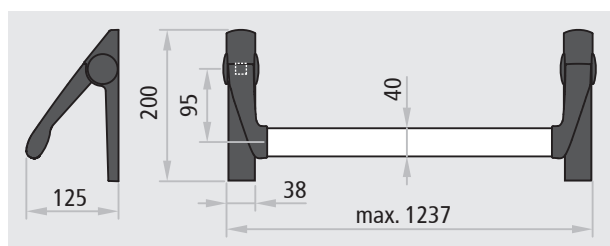

CERTIFICATIONS

Suitable for single-leaf doors and for the active or passive leaf of double-leaf doors up to 1350 x 2880 mm/leaf in size with a maximum weight of 300 kg/leaf.



Denomination	EXUS PANIC EXIT DEVICE
Manufacturer	Ninz S.p.A. Corso Trento, 2/A I-38061 ALA (TN)/ITALIA
Year application trademark	08
N° and year of the regulation	EN 1125:2008
Certification authority	0425
N° of CE certificate	1228-CPD-2007
Classification	3 7 7 B 1 3 2 1 A A

- 1° Category of use: high frequency
- 2° Durability: 200,000 cycles
- 3° Mass of door: over 200 kg
- 4° Suitable for fire/smoke doors
- 5° Safety: suitable for evacuation routes
- 6° Highly corrosion resistance 96 h
- 7° Safety of materials 1000 N
- 8° Protrusion of the bar: up to 150 mm
- 9° Activation type: push bar
- 10° Suitable for single- and double-leaf doors



EXUS® is a registered trademark owned by Ninz S.p.A.

Also suitable for doors with classifications up to:



ATTESTATO DI CONFORMITÀ DIRETTIVA 89/106/CEE CERTIFICATE OF CONFORMITY DIRECTIVE 89/106/CEE		CE 0425
Questo certificato è rilasciato in conformità a quanto prescritto dall'Art.6 par.2 lettera b) del DPR 21 aprile 1993, n°246 (Direttiva 89/106/CEE) ed attesta la conformità del prodotto di seguito identificato agli Art.1, Art.2 ed allegato A del DPR 21 aprile 1993, n°246 (Direttiva 89/106/CEE)		
This certificate has been issued in conformity to what prescribed by the Art.6 par.2 letter b) of the DPR 21/04/1993, n°246 (Directive 89/106/CEE) and certifies the conformity of the product described below to the Art.1, Art.2 and attachment A of DPR 21/04/1993, n°246 (Directive 89/106/CEE)		
ATTESTATO N°	1228 - CPD - 2007	CERTIFICATE N°
Organismo notificato	ICIM S.p.A. - Piazza A. Diaz, 2 - 20123 MILANO (ITALY)	Notified Body
N° d'identification:	0425	
Dati Fabbricante		Manufacturer
Sede legale	NINZ S.p.A. Corso Trento, 2/A 38061 ALA (TN) ITALY	Head office
Unità operativa		Operative unit
Dati prodotto		Product
Tipologia	DISPOSITIVI ANTIPANICO PER USCITE DI SICUREZZA AZIONATI MEDIANTE UNA BARRA ORIZZONTALE	Type
Denominazione	Dispositivo antipanico serie "TWIST" "EXUS LP" "EXUS LA" "EXUS LX"	Denomination
Serrature antipanico	art. AP16/18, SCA 1 3201001.019/020, 4506002.17 (V)	
Controserrature antipanico	art. AP020P, AP020U, 4506002.18 (V)	
Dispositivo superiore	art. 3105080, 3105024, 4506003 (V)	
Riscontro asta	art. 2401036, 2401046, 2401044, 4506005 (V)	
Boccola pavimento	art. 2401001, 2401007, 3105091, 4509006 (V)	
Aste verticali	art. 3305015, 3305016, 3305002, 4509003 (V)	
Riscontro serratura	art. 2401006, 2401005, 2401015, 2401014, 4506006 (V)	
Comandi esterni	art. BM, BSP, BS, BMC, BC, B, A, BM inox, BM alu, BSP inox, BSP alu	
Sistema di attestazione della conformità	1	Attestation of conformity
Norma di riferimento	EN1125:2008	Standard
Classificazione	3 7 7 B 1 3 2 1 A A	Classification
Eventuali estensioni	Nessuna / None	Extensions
Eventuali condizioni di subordinazione della Certificazione CE	Nessuna / None	Possible conditions of subordination of the CE Certification
Il presente attestato è valido esclusivamente per il prodotto indicato. Eventuali varianti da apportare devono essere approvate da ICIM SpA The present issue is valid only for the product described above. Possible changes to be brought in have to be approved by ICIM S.p.A.		
Data di emissione First issue	Emissione corrente Current Issue	Data di scadenza Expiring date
18/04/2007	07/05/2009	17/04/2017
ICIM S.p.A. Il Presidente Ing. Tullio Badino		

KIT EXUS® LP IN BLACK NYLON



Description

The EXUS LP panic exit device consists of a horizontal bar made of anodized aluminium that engages lever arms attached to control mechanisms in order to activate the latch mechanism.

- Reversible for right- or left-handed opening;
- Applicable to single-leaf or double-leaf doors;
- Suitable for PROGET/UNIVER/REVER and other types of panic doors;
- The horizontal bar is made of extruded anodized aluminium with an elliptical 40 x 20 mm cross section and a length of 1150 mm;
- The two lever arms are made of black nylon with a galvanized steel core;
- The two control mechanisms are made of galvanized steel with black nylon casing, one of which has an EXIT label to indicate the latch mechanism side;
- The panic/fire latch mechanism is for European profile cylinders;
- The external controls and mounting plates are made of black nylon, the under-plate is in galvanized steel.

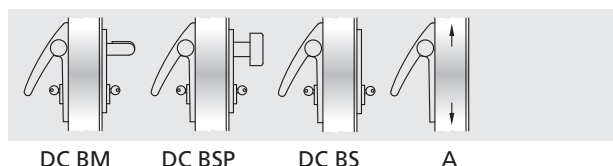
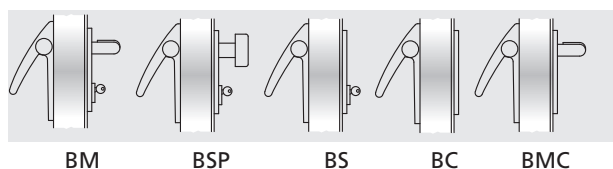

Optional variations (see p. 25)

- Aluminium bar painted in RAL colors
- External BM and BSP controls in polished stainless steel
- External BM and BSP controls painted in RAL colors
- MAC® 1 type panic latch mechanism with access control function
- Coded or mastered cylinders
- Microswitches and cable gland, for signaling when the door is open

AVAILABLE VERSIONS

KIT for single-leaf doors or the active leaf of double-leaf doors

KIT contents: 1 panic latch mechanism for 65 mm hole, 1 insert for the latch mechanism keeper, 2 control mechanisms, 2 black nylon cover casings, 2 black nylon lever arms, 1 anodized aluminium bar, 1 black nylon external control, 1 half-cylinder with 3 keys, 1 double cylinder with 3 keys (DC version only), 1 drilling guide, 1 adhesive pictogram (green arrow), 1 installation/maintenance manual

Article no.	KIT bar	Leaf thickness
4204301.001	EX LP BM*	60 mm
4204301.002	EX LP BSP	60 mm
4204301.003	EX LP BS	60 mm
4204301.004	EX LP BMC	60 mm
4204301.005	EX LP BC	60 mm
4204301.006	EX LP DC BM*	60 mm
4204301.007	EX LP DC BM*	50 mm
4204301.008	EX LP DC BM*	40 mm
4204301.009	EX LP DC BSP	60 mm
4204301.010	EX LP DC BSP	50 mm
4204301.011	EX LP DC BSP	40 mm
4204301.012	EX LP DC BS	60 mm
4204301.013	EX LP DC BS	50 mm
4204301.014	EX LP DC BS	40 mm

DC - Versions with feed-through cylinder

* versions that can be combined with the MAC® 1 latch mechanism

KIT for the passive leaf of double-leaf doors. Suitable for PROGET/UNIVER/REVER fire and multi-purpose doors.

KIT contents: 1 panic safety lock for 80 mm hole, 2 control mechanisms, 2 black nylon cover casings, 2 black nylon lever arms, 1 anodized aluminium bar, 1 upper relatch device, 1 floor-mounted bushing, 1 link arm (except for REVER and UNIVER MULTI-PURPOSE), 1 drilling guide, 1 adhesive pictogram (green arrow), 1 installation/maintenance manual

Article no.	KIT bar	Door
4204302.001	EX LP A	PROGET** fire and multi-purpose
4204302.002	EX LP A	UNIVER fire
4204302.003	EX LP A	REVER and UNIVER multi-purpose

** manufactured after 01.01.2005

KIT for the passive leaf of double-leaf doors. Suitable for other types of multi-purpose doors

KIT contents: 1 panic safety lock for 80 mm hole, 2 control mechanisms, 2 black nylon cover casings, 2 black nylon lever arms, 1 anodized aluminium bar, 1 upper relatch device, 1 upper keeper, 1 angle-iron support, 1 adjustable upper rod, 1 lower rod, 1 floor-mounted bushing, 1 link arm guide, 1 drilling guide, 1 adhesive pictogram (green arrow), 1 installation/maintenance manual

Article no.	KIT bar	Door
4204305.001	EX LP A	Other types of multi-purpose doors

KIT EXUS® LA IN ALUMINIUM



Description

The EXUS LA panic exit device consists of a horizontal bar made of anodized aluminium that engages lever arms attached to the control mechanisms in order to activate the latch mechanism.

- Reversible for right- or left-handed opening;
- Applicable to single-leaf and double-leaf doors;
- Suitable for PROGET/UNIVER/REVER and other types of panic doors;
- The horizontal bar is made of extruded anodized aluminium with an elliptical 40 x 20 mm cross section and a length of 1150 mm;
- The two lever arms are made of aluminium alloy with polished chromium-plated finishing;
- The two control mechanisms are made of galvanized steel with aluminium alloy cover casings with a polished chromium-plated finish, one of which has an EXIT label to indicate the latch mechanism side;
- The panic/fire latch mechanism is for European profile cylinders;
- The external controls consist of a handle or knob made of AISI 304 stainless steel and a mounting plate in aluminium alloy with polished chromium-plated finish;
- The lever arms, casings and handle plate are finished with trivalent chrome in compliance with the ROHS regulation.

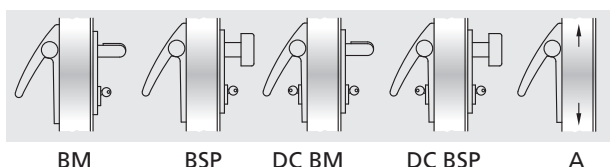

Optional variations (see p. 25)

- Aluminium bar painted in RAL colors
- MAC® 1 type panic latch mechanism with access control function
- Coded or mastered cylinders
- Microswitches and cable gland for signaling when the door is open

AVAILABLE VERSIONS

KIT for single-leaf doors or the active leaf of double-leaf doors

KIT contents: 1 panic latch mechanism for 65 mm hole, 1 insert for the latch mechanism keeper, 2 control mechanisms, 2 polished chromium-plated aluminium cover casings, 2 chromium-plated aluminium lever handles, 1 anodized aluminium bar, 1 stainless steel/aluminium external control, half-cylinder with 3 keys, 1 double cylinder with 3 keys (DC version only), 1 drilling guide, 1 adhesive pictogram (green arrow), 1 installation/maintenance manual.

Article no.	KIT bar	Leaf thickness
4204301.015	EX LA BM*	60 mm
4204301.016	EX LA BSP	60 mm
4204301.017	EX LA DC BM*	60 mm
4204301.018	EX LA DC BM*	50 mm
4204301.019	EX LA DC BM*	40 mm
4204301.020	EX LA DC BSP	60 mm
4204301.021	EX LA DC BSP	50 mm
4204301.022	EX LA DC BSP	40 mm

DC - Versions with feed-through cylinder

* versions compatible with the MAC® 1 latch mechanism

KIT for the passive leaf of double-leaf doors. Suitable for PROGET/UNIVER/REVER fire and multi-purpose doors

KIT contents: 1 panic safety lock for 80 mm hole, 2 control mechanisms, 2 polished chromium-plated aluminium cover casings, 2 polished chromium-plated aluminium lever arms, 1 anodized aluminium bar, 1 upper relatch device, 1 floor-mounted bushing, 1 link arm guide (except for REVER and UNIVER MULTI-PURPOSE), 1 drilling guide, 1 adhesive pictogram (green arrow), 1 installation/maintenance manual.

Article no.	KIT bar	Door
4204302.004	EX LA A	PROGET** fire and multi-purpose
4204302.005	EX LA A	UNIVER fire
4204302.006	EX LA A	REVER and UNIVER multi-purpose

**manufactured after 01.01.2005

KIT for the passive leaf of double-leaf doors. Suitable for other types of multi-purpose doors

KIT contents: 1 panic safety lock for 80 mm hole, 2 control mechanisms, 2 chromium-plated aluminium cover casings, 2 chromium-plated aluminium lever arms, 1 anodized aluminium bar, 1 upper re-latch device, 1 upper keeper, 1 angle-iron support, 1 adjustable upper rod, 1 lower rod, 1 floor-mounted bushing, 1 link arm guide, 1 drilling guide, 1 adhesive pictogram (green arrow), 1 installation/maintenance manual.

Article no.	KIT bar	Door
4204305.002	EX LA A	Other types of multi-purpose doors

KIT EXUS® LX IN STAINLESS STEEL



Description

The EXUS LX panic exit device is made entirely of stainless steel and consists of a horizontal bar that engages lever arms attached to the control mechanisms in order to activate the latch mechanism.

- Maximum corrosion resistance and considerable robustness of the entire system;
- Optimal aesthetic appeal;
- Reversible for right- or left-handed opening;
- Applicable to single-leaf or double-leaf doors;
- Suitable for PROGET/UNIVER/REVER and other types of panic doors;
- The horizontal bar is made of AISI 304 polished stainless steel with an elliptical 40 x 20 mm cross section and a length of 1150 mm;
- The two lever arms are made of AISI 304 polished stainless steel;
- The two control mechanisms are made of AISI 304 stainless steel;
- The two casings and cover plugs are made of AISI 304 polished stainless steel, and one has an EXIT label to indicate the latch mechanism side;
- The panic/fire latch mechanism is for European profile cylinders;
- The external controls and associated mounting plate are made of AISI 304 polished stainless steel, and the underplate is made of galvanized steel.

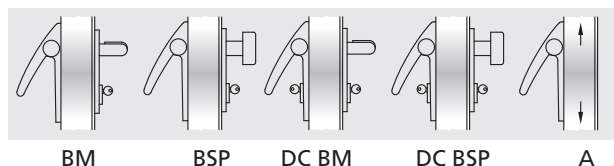

Optional variations (see p. 25)

- MAC® 1 type panic latch mechanism with access control function
- Coded or mastered cylinders
- Microswitches and cable gland for signaling when the door is open

AVAILABLE VERSIONS

KIT for single-leaf doors or the active leaf of double-leaf doors

KIT contents: 1 reversible panic latch mechanism for 65 mm holes, 1 insert for the latch mechanism keeper, 2 stainless steel control mechanisms, 2 stainless steel cover casings, 2 stainless steel lever handles, 1 stainless steel bar, 1 stainless steel external control, 1 half-cylinder with 3 keys, 1 double cylinder with 3 keys (DC version only), 1 drilling guide, 1 adhesive pictogram (green arrow), 1 installation/maintenance manual.

Article no.	KIT bar	Leaf thickness
4204301.023	EX LX BM*	60 mm
4204301.024	EX LX BSP	60 mm
4204301.025	EX LX DC BM*	60 mm
4204301.026	EX LX DC BM*	50 mm
4204301.027	EX LX DC BM*	40 mm
4204301.028	EX LX DC BSP	60 mm
4204301.029	EX LX DC BSP	50 mm
4204301.030	EX LX DC BSP	40 mm

DC - Versions with feed-through cylinder

* versions combinable with the MAC® 1 latch mechanism

KIT for the passive leaf of double-leaf doors. Suitable for PROGET/UNIVER/REVER fire and multi-purpose doors

KIT contents: 1 panic safety lock for 80 mm hole, 2 stainless steel control mechanisms, 2 stainless steel cover casings, 2 stainless steel lever arms, 1 stainless steel bar, 1 upper relatch device, 1 floor-mounted bushing, 1 link arm guide (except for REVER and UNIVER MULTI-PURPOSE), 1 drilling guide, 1 adhesive pictogram (green arrow), 1 installation/maintenance manual.

Article no.	KIT bar	Door
4204302.007	EX LX A	PROGET** fire and multi-purpose
4204302.008	EX LX A	UNIVER fire
4204302.009	EX LX A	REVER and UNIVER multi-purpose

** manufactured after 01.01.2005

KIT for the passive leaf of double-leaf doors. Suitable for other types of multi-purpose doors

KIT contents: 1 panic safety lock for 80 mm hole, 2 stainless steel control mechanisms, 2 stainless steel cover casings, 2 stainless steel lever arms, 1 stainless steel bar, 1 upper relatch device, 1 upper keeper, 1 angle-iron support, 1 adjustable upper rod, 1 lower rod, 1 floor-mounted bushing, 1 link arm guide, 1 drilling guide, 1 adhesive pictogram (green arrow), 1 installation/maintenance manual.

Article no.	KIT bar	Door
4204305.003	EX LX A	Other types of multi-purpose doors

KIT EXUS® LP and LA for glazed doors

Panic exit devices for insertable latch mechanisms - CE EN 1125:2008



KIT EXUS® LP IN BLACK NYLON



Description

The EXUS LP panic exit device consists of a horizontal bar that engages lever arms attached to the control mechanisms in order to activate the latch mechanism.

- Reversible for right- or left-handed opening;
- Applicable to glazed doors with one or two leaves;
- The horizontal bar is made of extruded anodized aluminium with an elliptical 40 x 20 mm cross section and a length of 1150 mm;
- The two lever arms are made of black nylon with a galvanized steel core;
- The two control mechanisms are made of galvanized steel with black nylon casing, one of which has an EXIT label to indicate the latch mechanism side;
- The panic/fire type latch mechanism is suitable for glazed doors and uses European profile cylinders;
- The external controls are made of shiny black resin.

AVAILABLE VERSIONS

Kit for single-leaf doors or the active leaf of double-leaf doors

KIT contents: 1 panic latch mechanism for 40 mm hole, 1 plate for the latch mechanism keeper, 2 control mechanisms, 2 black nylon cover casings, 2 black nylon lever handles, 1 anodized aluminium bar, 1 external control with a black resin rosette, 1 adhesive pictogram (green arrow), 1 installation/maintenance manual.

Article no.	KIT bar	Thickness up to
4204306.001	EX LP BM V	70 mm
4204306.002	EX LP DC BM V	70 mm

DC - Versions for feed-through cylinder (cylinder excluded), mechanisms in AISI 304 stainless steel

Kit for the passive leaf of double-leaf doors

KIT contents: 1 panic safety lock for 30 mm holes, 2 control mechanisms, 2 black nylon cover casings, 2 black nylon lever arms, 1 anodized aluminium bar, 1 upper relatch device, 1 upper keeper, 1 adjustable upper rod, 1 lower rod, 1 floor-mounted bushing, 1 adhesive pictogram (green arrow), 1 installation/maintenance manual.

Article no.	KIT bar	Thickness up to
4204306.003	EX LP A V	70 mm

KIT EXUS® LA IN ALUMINIUM



Description

The EXUS LA panic exit device consists of a horizontal bar that engages lever arms attached to the control mechanisms in order to activate the latch mechanism.

- Reversible for right- or left-handed opening;
- Applicable to glazed doors with one or two leaves;
- The horizontal bar is made of extruded anodized aluminium with an elliptical 40 x 20 mm cross section and a length of 1150 mm;
- The two lever arms are made of aluminium alloy with polished chromium-plated finish;
- The two control mechanisms are made of galvanized steel with aluminium alloy cover casings and a polished chromium-plated finish, one of which has an EXIT label to indicate the latch mechanism side;
- The latch mechanism is panic/fire type suited for glazed doors and uses European profile cylinders;
- The external controls are made of polished stainless steel;
- The arms and casings are finished with trivalent chrome in compliance with the ROHS regulation.

AVAILABLE VERSIONS

Kit for single-leaf doors or the active leaf of double-leaf doors

KIT contents: 1 panic latch mechanism for 40 mm holes, 1 plate for the latch mechanism keeper, 2 control mechanisms, 2 polished chromium-plated aluminium cover casings, 2 glossy chromium-plated aluminium lever handles, 1 anodized aluminium bar, 1 external control with stainless steel rosette, 1 adhesive pictogram (green arrow), 1 installation/maintenance manual.

Article no.	KIT bar	Thickness up to
4204306.004	EX LA BM V	70 mm
4204306.005	EX LA DC BM V	70 mm

DC - Versions for feed-through cylinder (cylinder excluded), mechanisms in AISI 304 stainless steel

Kit for the passive leaf of double-leaf doors

KIT contents: 1 panic safety lock for 30 mm holes, 2 control mechanisms, 2 polished chromium-plated aluminium cover casings, 2 polished chromium-plated aluminium lever arms, 1 anodized aluminium bar, 1 upper relatch device, 1 upper keeper, 1 adjustable upper rod, 1 lower rod, 1 inset floor-mounted bushing, 1 adhesive pictogram (green arrow), 1 installation/maintenance manual.

Article no.	KIT bar	Thickness up to
4204306.006	EX LA A V	70 mm

KIT EXUS® LX for glazed doors

Panic exit devices for insertable latch mechanisms - CEN 1125:2008



KIT EXUS® LX IN STAINLESS STEEL



Description

The EXUS LX panic exit device is made entirely of stainless steel and consists of a horizontal bar that engages lever arms attached to the control mechanisms in order to activate the latch mechanism.

- Maximum corrosion resistance and considerable robustness of the entire system;
- Optimal aesthetic appeal;
- Reversible for right- or left-handed opening;
- Applicable to glazed doors with single or double leaves;
- The horizontal bar is made of AISI 304 polished stainless steel with an elliptical 40 x 20 mm cross section and a length of 1150 mm;
- The two lever arms are made of AISI 304 polished stainless steel;
- The two control mechanisms are made of AISI 304 stainless steel;
- The two casings and cover plugs are made of AISI 304 polished stainless steel, and one has an EXIT label to indicate the latch mechanism side;
- The latch mechanism is panic/fire type suited for glazed doors and uses European profile cylinders;
- The external controls are made of polished stainless steel.

AVAILABLE VERSIONS

KIT for single-leaf doors or the active leaf of double-leaf doors

KIT contents: 1 reversible panic latch mechanism for 40 mm hole, 1 plate for the latch mechanism keeper, 2 stainless steel control mechanisms, 2 stainless steel cover casings, 2 stainless steel lever arms, 1 stainless steel bar, 1 stainless steel external control with rosette, 1 adhesive pictogram (green arrow), 1 installation/maintenance manual.

Article no.	KIT bar	Thickness up to
4204306.007	EX LX BM V	70 mm
4204306.008	EX LX DC BM V	70 mm

DC - Versions for feed-through cylinder (cylinder excluded)

KIT for the passive leaf of double-leaf doors

KIT contents: 1 panic safety lock for 30 mm holes, 2 stainless steel control mechanisms, 2 stainless steel cover casings, 2 stainless steel lever arms, 1 stainless steel bar, 1 upper relatch device, 1 upper keeper, 1 adjustable upper rod, 1 lower rod, 1 floor-mounted bushing, 1 adhesive pictogram (green arrow), 1 installation/maintenance manual.

Article no.	KIT bar	Thickness up to
4204306.009	EX LX A V	70 mm

EXTERNAL CONTROLS FOR GLAZED DOORS

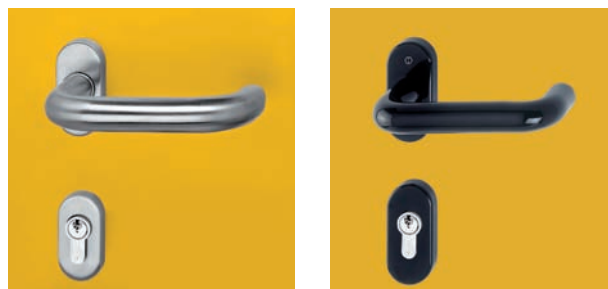

Article no.	Description
4211104.002	Stainless steel handle with rosette, polished finish, series standard for KIT EXUS LA and LX
4211104.001	Handle made of shiny black resin with rosette, series standard for EXUS LP

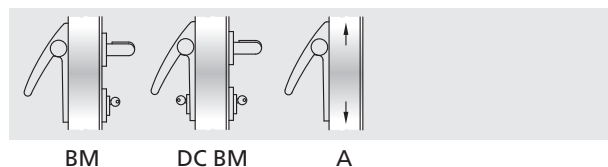

Optional variations (see p. 25)

- Microswitches and cable gland for signaling when the door is open
- The LP and LA versions can have an RAL tinted horizontal bar
- The LP versions can have a polished stainless steel handle

NOTE

It is obligatory to apply a link arm guide to passive leaves in order to ensure proper functioning of the closing sequencer and, if necessary, to prevent the two leaves from getting stuck when opened simultaneously.

Twist

TWIST



PRESENTATION

TWIST panic exit devices

TWIST exit devices are certified **CE** according to European regulation UNI EN 1125:2008, which entered into effect on the 1st of January 2010, and includes a series of substantive innovations that extends the maximum safety and ease of opening requirements.

The KIT to fit your needs

The entire **TWIST** exit device series is proposed in elegant and functional KITS in the most appropriate framework for distributors.

KIT-based packaging ensures that clients, installers and end users alike receive complete panic exit systems for which all parts are fully and safely **CE** certified in every respect.

Finishing

The **TWIST** panic exit device series is proposed in the **black NYLON** version with an **anodized ALUMINIUM** bar. Bars and external controls may also be requested in RAL tints, opening up an infinite number of aesthetic solutions.

Certifications and spare parts

Given the importance of maintaining **CE** certification for the entire system, spare parts have been dedicated special attention because of the essential role they play within the overall system tested in accordance with regulation UNI EN 1125:2008.

Only **original NINZ replacement parts**, therefore, can ensure that the product retains the same characteristics over time.

For this reason, the instructions for the **TWIST** panic exit device also include, in addition to directions for correct installation and maintenance, an exploded drawing that identifies every smallest detail of the certified system and all the necessary references for ordering replacement parts.

With the new packaging of **TWIST** panic exit devices, NINZ S.p.A. demonstrates its eagerness to develop the market by investing in projects and business image in order to add value to its own products while maintaining highly competitive quality-price ratios.



Black NYLON handle

NOTE

The standard **TWIST** exit device is combined with black NYLON handles.

TWIST - Characteristics, certifications

Panic exit device

NINZ
FIREDOORS

CHARACTERISTICS

- Panic exit device with a classic but ever-fashionable line, available in the standard combination of black nylon arms/casings with an anodized aluminium bar;
- Certified for insertable latch mechanisms with 65 mm openings for single leaves and active leaves, and with 80 mm openings for passive leaves;
- Reversible for assembly on right- or left-hand opening doors;
- Protrusion 100 mm;
- Proposed in complete KIT in a single black/green box;
- Package label indicates the product specifications;
- Wide variety of options: colored bars, colored or stainless steel handles, latch mechanisms with access control functions, special coded or mastered cylinders.

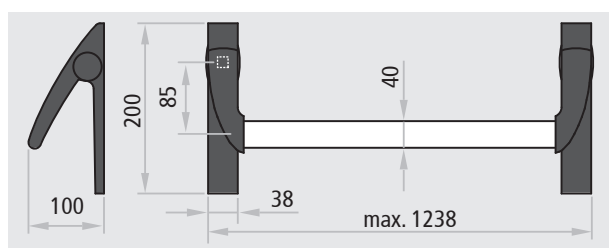

CERTIFICATION

Suitable for single-leaf doors and for the active or passive leaf of double-leaf doors of up to 1350 x 2880 mm/leaf in size and a maximum weight of 300 kg/leaf.



Denomination	TWIST PANIC EXIT DEVICE
Manufacturer	Ninz S.p.A. Corso Trento, 2/A I-38061 ALA (TN)/ITALIA
Year application trademark	08
N° and year of the regulation	EN 1125:2008
Certification authority	0425
N° of CE certificate	1228-CPD-2007
Classification	3 7 7 B 1 3 2 1 A A

- 1° Category of use: high frequency
- 2° Durability: 200,000 cycles
- 3° Mass of door: over 200 kg
- 4° Suitable for fire/smoke doors
- 5° Safety: suitable for evacuation routes
- 6° Highly corrosion resistance 96 h
- 7° Safety of materials 1000 N
- 8° Protrusion of the bar: up to 150 mm
- 9° Activation type: push bar
- 10° Suitable for single- or double-leaf doors



Also suitable for doors with classifications up to:



ATTESTATO DI CONFORMITÀ DIRETTIVA 89/106/CEE CERTIFICATE OF CONFORMITY DIRETTIVE 89/106/CEE		CE 0425
Questo certificato è rilasciato in conformità a quanto prescritto dall'Art.6 par.2 lettera b) del DPR 21 aprile 1993, n°246 (Direttiva 89/106/CEE) ed attesta la conformità del prodotto di seguito identificato agli Art.1, Art.2 ed allegato A del DPR 21 aprile 1993, n°246 (Direttiva 89/106/CEE). This certificate has been issued in conformity to what prescribed by the Art.6 par.2 letter b) of the DPR 21/04/1993, n°246 (Directive 89/106/EEC) and certifies the conformity of the product described below to the Art.1, Art.2 and attachment A of DPR 21/04/1993, n°246 (Directive 89/106/EEC).		
ATTESTATO N°	1228 - CPD - 2007	CERTIFICATE N°
Organismo notificato	ICIM S.p.A. - Piazza A. Diaz, 2 - 20123 MILANO (ITALY)	Notified Body
Dati Fabbricante	NINZ S.p.A. Corso Trento, 2/A 38061 ALA (TN) ITALY	Manufacturer
Sede legale	NINZ S.p.A. Corso Trento, 2/A 38061 ALA (TN) ITALY	Head office
Unità operativa		Operative unit
Dati prodotto	Product	
Tipologia	DISPOSITIVI ANTIPANICO PER USCITE DI SICUREZZA AZIONATI MEDIANTE UNA BARRA ORIZZONTALE PANIC EXIT DEVICES	
Denominazione	Dispositivo antipatico serie "TWIST" "EXUS LP" "EXUS LA" "EXUS LX"	Denomination
Serrature antipatico	art. AP16/18, SCA 1 3201001.019/020, 4506002.17 (V)	
Controserrature antipatico	art. AP020P, AP020U, 4506002.18 (V)	
Dispositivo superiore	art. 3105080, 3105024, 4506003 (V)	
Riscontro asta	art. 2401036, 2401046, 2401044, 4506005 (V)	
Boccola pavimento	art. 2401001, 2401007, 3105091, 4509006 (V)	
Aste verticali	art. 3305015, 3305016, 3305002, 4509003 (V)	
Riscontro serratura	art. 2401006, 2401005, 2401015, 2401014, 4506006 (V)	
Comandi esterni	art. BM, BSP, BS, BMC, BC, B, A, BM inox, BM alu, BSP inox, BSP alu	
Sistema di attestazione della conformità	1	Attestation of conformity
Norma di riferimento	EN1125:2008	Standard
Classificazione	3 7 7 B 1 3 2 1 A A	Classification
Eventuali estensioni	Nessuna / None	Extensions
Eventuali condizioni di subordinazione della Certificazione CE	Nessuna / None	Possible conditions of subordination of the CE Certification
Il presente attestato è valido esclusivamente per il prodotto indicato. Eventuali varianti da apportare devono essere approvate da ICIM SpA. The present issue is valid only for the product described above. Possible changes to be brought in have to be approved by ICIM S.p.A.		
Data di emissione First issue	Emissione corrente Current Issue	Data di scadenza Expiring date
18/04/2007	07/05/2009	17/04/2017
		ICIM S.p.A. Il Presidente Ing. Tullio Badino

KIT TWIST

Panic exit device for insertable latch mechanisms - CEN EN 1125:2008

NINZ
FIREDOORS

KIT TWIST IN BLACK NYLON



Description

The nylon TWIST panic exit device consists of a horizontal bar made of anodized aluminium that engages lever arms attached to the control mechanisms in order to activate the latch mechanism.

- Reversible for right- or left-handed opening;
- Applicable to single-leaf and double-leaf doors;
- Suitable for PROGET/UNIVER/REVER and other types of panic doors;
- The horizontal bar is made of extruded anodized aluminium with an elliptical 40 x 20 mm cross section and a length of 1150 mm;
- The two lever arms are made of black nylon with a galvanized steel core;
- The two control mechanisms are made of galvanized steel with black nylon casing, one of which has an EXIT label to indicate the latch mechanism side;
- The panic/fire latch mechanism is for European profile cylinders;
- The external controls and mounting plates are made of black nylon, and the under-plate is in galvanized steel.

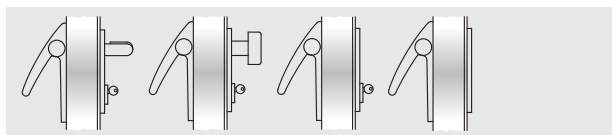

BM

BSP

BS

BC

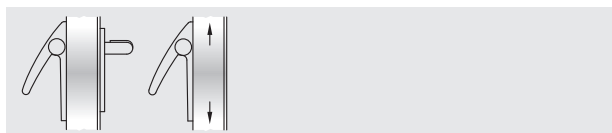

BMC

A

Optional variations (see p. 25)

- Aluminium bar painted in RAL colors
- External BM and BSP controls in polished stainless steel
- External BM and BSP controls painted in RAL colors
- MAC® 1 type panic latch mechanism with access control function
- Coded or mastered cylinders
- Microswitches and cable gland for signaling when the door is open

AVAILABLE VERSIONS

KIT for single-leaf doors or the active leaf of double-leaf doors

KIT contents: 1 panic latch mechanism for 65 mm holes, 1 insert for the latch mechanism keeper, 2 control mechanisms, 2 black nylon cover casings, 2 black nylon lever handles, 1 anodized aluminium bar, 1 black nylon external control, 1 half-cylinder with 3 keys, 1 drilling guide, 1 adhesive pictogram (green arrow), 1 installation/maintenance manual.

Article no.	KIT bar	Leaf thickness
4204301.031	TW BM*	60 mm
4204301.032	TW BSP	60 mm
4204301.033	TW BS	60 mm
4204301.034	TW BMC	60 mm
4204301.035	TW BC	60 mm

*version combinable with the MAC® 1 latch mechanism

KIT for the passive leaf of double-leaf doors. Suitable for PROGET/UNIVER/REVER fire and multi-purpose doors

KIT contents: 1 panic safety lock for 80 mm hole, 2 control mechanisms, 2 black nylon cover casings, 2 black nylon lever arms, 1 anodized aluminium bar, 1 upper relatch device, 1 floor-mounted bushing, 1 link arm guided (except for REVER and UNIVER MULTI-PURPOSE), 1 drilling guide, 1 adhesive pictogram (green arrow), 1 installation/maintenance manual.

Article no.	KIT bar	Doors
4204302.010	TW A	PROGET** fire and multi-purpose
4204302.011	TW A	UNIVER fire
4204302.012	TW A	REVER and UNIVER multi-purpose

** manufactured after 01.01.2005

KIT for the passive leaf of double-leaf doors. Suitable for other types of multi-purpose doors

KIT contents: 1 panic safety lock for 80 mm hole, 2 control mechanisms, 2 black nylon cover casings, 2 black nylon lever arms, 1 anodized aluminium bar, 1 upper relatch device, 1 upper keeper, 1 angle-iron support, 1 adjustable upper rod, 1 lower rod, 1 floor-mounted bushing, 1 link arm guide, 1 drilling guide, 1 adhesive pictogram (green arrow), 1 installation/maintenance manual.

Article no.	KIT bar	Door
4204305.004	TW A	Other types of multi-purpose doors

SLASH

HSVT5

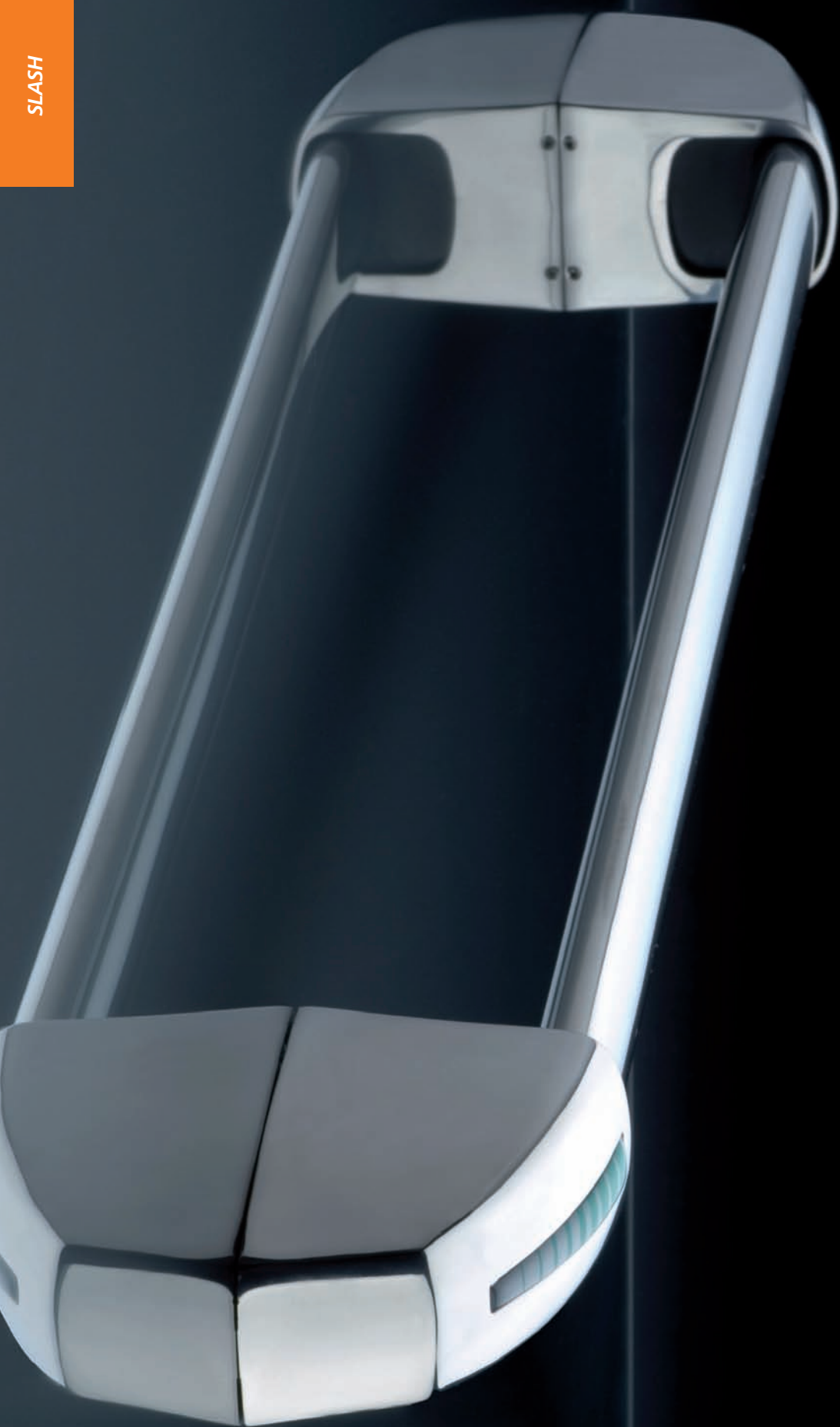

PRESENTATION

SLASH panic exit devices

Ninz S.p.A., leader in fire doors, has once again proven its forward-looking vision with ongoing research that endows its products with a strong identity in terms of design and technology, such as its new series of **SLASH** panic exit devices.

SLASH exit devices are certified **CE** according to European standard UNI EN 1125:2008, which entered into effect on the 1st of January 2010, and includes a series of substantive innovations that extends the maximum safety and ease of opening requirements.

The KIT to fit your needs

The entire **SLASH** exit device series is proposed in elegant and functional KITS in the most appropriate framework for distributors.

KIT packaging ensures that clients, installers and end users alike receive a complete panic exit system with all parts fully and safely **CE** certified in every respect.

Finishing

New combinations have been created in addition to the **black NYLON** version with an **anodized ALUMINIUM** bar, such as the all **polished STAINLESS STEEL** version and the **polished chromium-plated ALUMINIUM** with an **anodized ALUMINIUM** bar. Many other color and surface combinations are available for equally aesthetic solutions.

Certifications and spare parts

Give the importance on maintaining **CE** certification for the entire system, replacement parts have received special attention due to their critical role in maintaining the certification of an overall system tested according to regulation UNI EN 1125:2008.

Only **original NINZ replacement parts**, therefore, can ensure that the product retains the necessary characteristics over time.

In addition to installation and maintenance instructions, this is why the instructions for the **SLASH** panic exit device include an exploded drawing that identifies every smallest detail of the certified system and provides all the references needed for ordering replacement parts.

The expansion and the new packaging of the **SLASH** panic exit devices, demonstrates the eagerness of NINZ S.p.A. to develop the market by investing in projects and business image in order to add value to its own products while maintaining highly competitive quality-price ratios.



Black NYLON handle

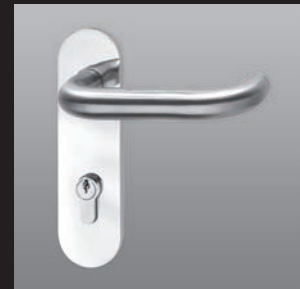

ALUMINIUM handle with
STAINLESS STEEL lever and
chromium-plated ALUMINIUM
plate



Polished STAINLESS STEEL handle

NOTE

The external controls of this series have the same finishing as the exit device.

SLASH - Characteristics, certifications

Panic exit device

NINZ
FIREDOORS

CHARACTERISTICS

- Panic exit device that stands out for its particular design and the rounded form of the casings. In addition to improving its aesthetic appeal, this helps reduce the risk of mishaps during use;
- Available in different color and surface combinations, in polished stainless steel cover casings and bar, or in polished chromium-plated aluminium casing with an anodized aluminium bar, or in the ever-fashionable classic combination of black nylon casings with an anodized aluminium bar;
- Certified for insertable latch mechanisms with 65 mm openings for single leaves and active leaves and 80 mm openings for passive leaves;
- Reversible for right- or left-handed opening;
- Protrusion 75 mm;
- Proposed as a complete KIT in a single black/orange box;
- Package label indicates the product characteristics;
- Wide range of options: colored bar, colored or stainless steel handles, latch mechanisms with access control functions, special coded or mastered cylinders.

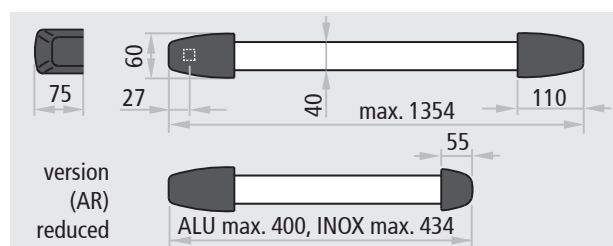

CERTIFICATION

Suitable for single-leaf doors and for the active or passive leaf of double-leaf doors up to 1350 x 2880 mm/leaf in size with a maximum weight of 300 kg/leaf.

Denomination	SLASH PANIC EXIT DEVICE
Manufacturer	Ninz S.p.A. Corso Trento, 2/A I-38061 ALA (TN)/ITALIA
Year application trademark	08
N° and year of the regulation	EN 1125:2008
Certification authority	0425
N° of CE certificate	1308-CPD-2007
Classification	3 7 7 B 1 3 2 2 B A

- 1° Category of use: high frequency
- 2° Durability: 200,000 cycles
- 3° Mass of door: over 200 kg
- 4° Suitable for fire/smoke doors
- 5° Safety: suitable for evacuation routes
- 6° High corrosion resistance 96 h
- 7° Safety of materials 1000 N
- 8° Protrusion of the bar: up to 100 mm
- 9° Activation type: touch bar
- 10° Suitable for single- or double-leaf doors



Also suitable for doors with classification up to:

EI₂120 REI 120 anti-smoke



ATTESTATO DI CONFORMITÀ DIRETTIVA 89/106/CEE CERTIFICATE OF CONFORMITY DIRETTIVE 89/106/CEE		CE 0425
Questo certificato è rilasciato in conformità a quanto prescritto dall'Art.6 par.2 lettera b) del DPR 21 aprile 1993, n°246 (Direttiva 89/106/CEE) ed attesta la conformità del prodotto di seguito identificato agli Art.1, Art.2 ed. allegato A del DPR 21 aprile 1993, n°246 (Direttiva 89/106/CEE). This certificate has been issued in conformity to what prescribed by the Art.6 par.2 letter b) of the DPR 21/04/1993, n°246 (Directive 89/106/EEC) and certifies the conformity of the product described below to the Art.1, Art.2 and attachment A of DPR 21/04/1993, n°246 (Directive 89/106/EEC).		
ATTESTATO N°	1308 - CPD - 2007	CERTIFICATE N°
Organismo notificato	ICIM S.p.A. - Piazza A. Diaz, 2 - 20123 MILANO (ITALY)	Notified Body
Dati Fabbricante	NINZ S.p.A. Corso Trento, 2/A 38061 ALA (TN) ITALY	Manufacturer
Sede legale	NINZ S.p.A. Corso Trento, 2/A 38061 ALA (TN) ITALY	Head office
Unità operativa		Operative unit
Dati prodotto	Product	
Tipologia	DISPOSITIVI ANTIPANICO PER USCITE DI SICUREZZA AZIONATI MEDIANTE UNA BARRA ORIZZONTALE PANIC EXIT DEVICES	
Denominazione	Dispositivo antipanico	Modello: "SLASH", "SLASH AR", "SLASH ALU", "SLASH ALU AR", "SLASH INOX", "SLASH INOX AR"
Serrature antipanico	art. AP16/18, SCA 1 3201001.019/020	
Controserrature antipanico	art. AP020P, AP020U	
Dispositivo superiore	art. 3105080, 3105024	
Riscontro asta	art. 2401036, 2401046, 2401044	
Boccola pavimento	art. 2401001, 2401007, 3105091	
Aste verticali	art. 3305015, 3305016, 3305002	
Riscontro serratura	art. 2401006, 2401005, 2401015, 2401014	
Comandi esterni	art. BM, BSP, BS, BMC, BC, B, A, BM inox, BM alu, BSP inox, BSP alu	
Sistema di attestazione della conformità	1	Attestation of conformity
Norma di riferimento	EN1125:2008	Standard
Classificazione	3 7 7 B 1 3 2 2 B A	Classification
Eventuali estensioni	Nessuna / None	Extensions
Eventuali condizioni di subordinazione della Certificazione CE	Nessuna / None	Possible conditions of subordination of the CE Certification
Il presente attestato è valido esclusivamente per il prodotto indicato. Eventuali varianti da apportare devono essere approvate da ICIM SpA. The present issue is valid only for the product described above. Possible changes to be brought in have to be approved by ICIM SpA.		
Data di emissione First issue	Emissione corrente Current issue	Data di scadenza Expiring date
31/05/2007	08/09/2009	30/05/2017
		ICIM S.p.A. Il Presidente Ing. Tullio Badino

KIT SLASH IN BLACK NYLON

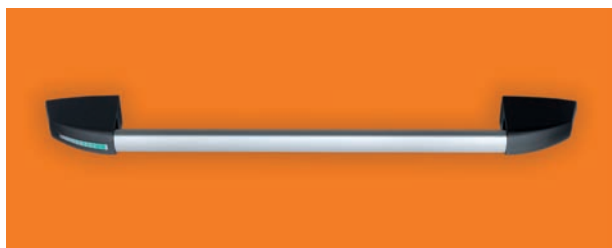

Description

The nylon SLASH panic exit device consists of a horizontal bar made of anodized aluminium and an internal connector tube that engages the control mechanisms in order to activate the latch mechanism.

- Reversible for right- or left-handed opening;
- Applicable to single-leaf and double-leaf doors;
- Suitable for PROGET/UNIVER/REVER and other types of panic doors;
- The horizontal bar is made of extruded anodized aluminium with an elliptical 40 x 20 mm cross section and a length of 1150 mm;
- The two control mechanisms are made of galvanized steel with black nylon cover casings, one of which has an EXIT label to indicate the latch mechanism side;
- The panic/fire latch mechanism is for European profile cylinders;
- The external controls and mounting plates are made of black nylon, and the under-plate is in galvanized steel.

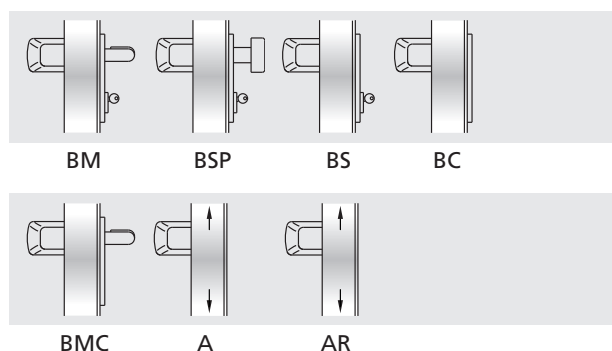

Optional variations (see p. 25)

- Aluminium bar painted in RAL colors
- External BM and BSP controls in polished stainless steel
- External BM and BSP controls painted in RAL colors
- MAC® 1 type panic latch mechanism with access control function
- Coded or mastered cylinders
- Microswitches and cable gland for signaling when the door is open

AVAILABLE VERSIONS

KIT for single-leaf doors or the active leaf of double-leaf doors

KIT contents: 1 panic latch mechanism for 65 mm holes, 1 insert for the latch mechanism keeper, 2 control mechanisms, 2 black nylon cover casings, 1 anodized aluminium bar with connector tube and spacer, 1 nylon hole-covering plate in RAL color 9006 with under-plate, 1 black nylon external control, 1 half-cylinder with 3 keys, 1 drilling guide, 1 adhesive pictogram (green arrow), 1 installation/maintenance manual.

Article no.	KIT bar	Leaf thickness
4204301.036	SL BM*	60 mm
4204301.037	SL BSP	60 mm
4204301.038	SL BS	60 mm
4204301.039	SL BMC	60 mm
4204301.040	SL BC	60 mm

*version combinable with the MAC® 1 latch mechanism

KIT for the passive leaf of double-leaf doors. Suitable for PROGET/UNIVER/REVER fire and multi-purpose doors

KIT contents: 1 panic safety lock for 80 mm holes, 2 control mechanisms, 2 black nylon cover casings, 1 anodized aluminium bar with connector tube and spacer, 1 upper relatch device, 1 floor-mounted bushing, 1 link arm guide (except for REVER and UNIVER MULTI-PURPOSE), 1 drilling guide, 1 adhesive pictogram (green arrow), 1 installation/maintenance manual.

Article no.	KIT bar	Door
4204302.013	SL A	PROGET** fire and multi-purpose
4204302.014	SL A	UNIVER fire
4204302.015	SL A	REVER and UNIVER multi-purpose
4204302.016	SL AR	PROGET** fire and multi-purpose
4204302.017	SL AR	UNIVER fire
4204302.018	SL AR	REVER and UNIVER multi-purpose

AR (reduced) for use on passive leaves with a width of FM L2 ≤ 500mm

** manufactured after 01.01.2005

KIT for the passive leaf of double-leaf doors. Suitable for other types of multi-purpose doors

KIT contents: 1 panic safety lock for 80 mm hole, 2 control mechanisms, 2 black nylon cover casings, 1 anodized aluminium bar with connector tube and spacer, 1 upper relatch device, 1 upper keeper, 1 angle-iron support, 1 adjustable upper rod, 1 lower rod, 1 floor-mounted bushing, 1 link arm guide, 1 drilling guide, 1 adhesive pictogram (green arrow), 1 installation/maintenance manual.

Article no.	KIT bar	Door
4204305.005	SL A	Other types of multi-purpose doors
4204305.006	SL AR	Other types of multi-purpose doors

AR (ridotto) da usare per anta passiva con larghezza FM L2 ≤ 500mm

KIT SLASH IN ALUMINIUM



Description

The SLASH ALU panic exit device consists of a horizontal bar made of anodized aluminium and an internal connector tube that engages the control mechanisms in order to activate the latch mechanism.

- Reversible for right- or left-handed opening;
- Applicable to single-leaf and double-leaf doors;
- Suitable for PROGET/UNIVER/REVER and other types of panic doors;
- The horizontal bar is made of extruded anodized aluminium with an elliptical 40 x 20 mm cross section and a length of 1150 mm;
- The two control mechanisms are made of galvanized steel with aluminium alloy cover casings with a polished chromium-plated finish, one of which has a green label to indicate the latch mechanism side;
- The panic/fire latch mechanism is for European profile cylinders;
- The external controls consist of a handle or knob made of AISI 304 stainless steel and a mounting plate in aluminium alloy with a polished chromium-plated finish;
- The casings and handle plate are finished with trivalent chrome in compliance with the ROHS regulation.

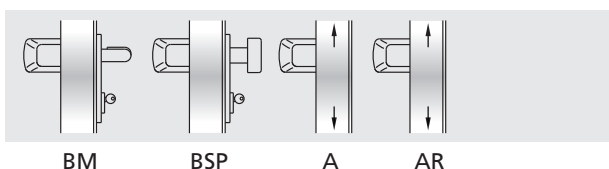

Optional variations (see p. 25)

- Aluminium bar painted in RAL colors
- MAC® 1 type panic latch mechanism with access control function
- Coded or mastered cylinders
- Microswitches and cable gland for signaling when the door is open

AVAILABLE VERSIONS

KIT for single-leaf doors or the active leaf of double-leaf doors

KIT contents: 1 panic latch mechanism for 65 mm holes, 1 insert for the latch mechanism keeper, 2 control mechanisms, 2 polished chromium-plated aluminium cover casings, 1 anodized aluminium bar with connector tube and spacer, 1 black nylon hole-covering plate with under-plate, 1 stainless steel/aluminium external control, 1 half-cylinder with 3 keys, 1 drilling guide, 1 adhesive pictogram (green arrow), 1 installation/maintenance manual.

Article no.	KIT bar	Leaf thickness
4204301.041	SL ALU BM*	60 mm
4204301.042	SL ALU BSP	60 mm

*version combinable with the MAC® 1 latch mechanism

KIT for the passive leaf of double-leaf doors. Suited for PROGET/UNIVER/REVER fire and multi-purpose doors

KIT contents: 1 panic safety lock for 80 mm hole, 2 control mechanisms, 2 polished chromium-plated aluminium cover casings, 1 anodized aluminium bar with connector tube and spacer, 1 upper relatch device, 1 floor-mounted bushing, 1 link arm guide (except for REVER and UNIVER MULTI-PURPOSE), 1 drilling guide, 1 adhesive pictogram (green arrow), 1 installation/maintenance manual.

Article no.	KIT bar	Door
4204302.019	SL ALU A	PROGET** fire and multi-purpose
4204302.020	SL ALU A	UNIVER fire
4204302.021	SL ALU A	REVER and UNIVER multi-purpose
4204302.022	SL ALU AR	PROGET** fire and multi-purpose
4204302.023	SL ALU AR	UNIVER fire
4204302.024	SL ALU AR	REVER and UNIVER multi-purpose

AR (reduced) for use on passive leaves with a width of FM L2 ≤ 500mm
**manufactured after 01.01.2005

KIT for the passive leaf of double-leaf doors. Suitable for other types of multi-purpose doors

KIT contents: 1 panic safety lock for 80 mm hole, 2 control mechanisms, 2 chromium-plated aluminium cover casings, 1 anodized aluminium bar with connector tube and spacer, 1 upper relatch device, 1 upper keeper, 1 angle-iron support, 1 adjustable upper rod, 1 lower rod, 1 floor-mounted bushing, 1 link arm guide, 1 drilling guide, 1 adhesive pictogram (green arrow), 1 installation/maintenance manual.

Article no.	KIT bar	Door
4204305.007	SL ALU A	Other types of multi-purpose doors
4204305.008	SL ALU AR	Other types of multi-purpose doors

AR (reduced) for use on passive leaves with a width of FM L2 ≤ 500mm

KIT SLASH IN STAINLESS STEEL



Description

The stainless steel SLASH panic exit device consists of a horizontal bar made of stainless steel and an internal connector tube that engages the control mechanisms in order to activate the latch mechanism.

- Optimal resistance to corrosion and shocks;
- Avant garde aesthetic appeal;
- Secure attachment of casing;
- Reversible for right- or left-handed opening;
- Applicable to single-leaf and double-leaf doors;
- Suitable for PROGET/UNIVER/REVER and other types of panic doors;
- The horizontal bar is made of AISI 304 polished stainless steel with an elliptical 40 x 20 mm cross section and 1150 mm length and equipped with a connector tube;
- The two control mechanisms are made of galvanized steel with AISI 304 polished stainless steel cover casings, one of which has green label to indicate the latch mechanism side;
- The panic/fire latch mechanism is for European profile cylinders;
- The external controls and related mounting plate are made of AISI 304 polished stainless steel, and the underplate is made of galvanized steel.

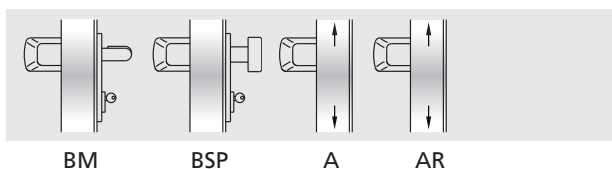

Optional variations (see p. 25)

- MAC® 1 type panic latch mechanism with access control function
- Coded or mastered cylinders
- Microswitches and cable gland for signaling when the door is open

AVAILABLE VERSIONS

KIT for single-leaf doors or the active leaf of double-leaf doors

KIT contents: 1 reversible panic latch mechanism for 65 mm holes, 1 insert for the latch mechanism keeper, 2 stainless steel control mechanisms, 2 stainless steel cover casings, 1 stainless steel bar with connector tube and spacer, 1 black nylon hole-covering plate with underplate, 1 stainless steel external control, 1 half-cylinder with 3 keys, 1 drilling guide, 1 adhesive pictogram (green arrow), 1 installation/maintenance manual.

Article no.	KIT bar	Leaf thickness
4204301.043	SL inox BM*	60 mm
4204301.044	SL inox BSP	60 mm

*version combinable with the MAC® 1 latch mechanism

KIT for the passive leaf of double-leaf doors. Suitable for PROGET/UNIVER/REVER fire and multi-purpose doors

KIT contents: 1 panic safety lock for 80 mm holes, 2 control mechanisms, 2 stainless steel cover casings, 1 stainless steel bar with connector tube and spacer, 1 upper relatch device, 1 floor-mounted bushing, 1 link arm guide (except for REVER and UNIVER MULTI-PURPOSE), 1 drilling guide, 1 adhesive pictogram (green arrow), 1 installation/maintenance manual.

Article no.	KIT bar	Door
4204302.025	SL inox A	PROGET** fire and multi-purpose
4204302.026	SL inox A	UNIVER fire
4204302.027	SL inox A	REVER and UNIVER multi-purpose
4204302.028	SL inox AR	PROGET** fire and multi-purpose
4204302.029	SL inox AR	UNIVER fire
4204302.030	SL inox AR	REVER and UNIVER multi-purpose

AR (reduced) for use on passive leaves with a width of FM L2 ≤ 500mm

**manufactured after 01.01.2005

KIT for the passive leaf of double-leaf doors. Suitable for other types of multi-purpose doors

KIT contents: 1 panic safety lock for 80 mm holes, 2 control mechanisms, 2 stainless steel cover casings, 1 stainless steel bar with connector tube and spacer, 1 upper relatch device, 1 upper keeper, 1 angle-iron support, 1 adjustable upper rod, 1 lower rod, 1 floor-mounted bushing, 1 link arm guide, 1 drilling guide, 1 adhesive pictogram (green arrow), 1 installation/maintenance manual.

Article no.	KIT bar	Door
4204305.009	SL inox A	Other types of multi-purpose doors
4204305.010	SL inox AR	Other types of multi-purpose doors

AR (reduced) for use on passive leaves with a width of FM L2 ≤ 500mm

CERTIFIED SYSTEM COMPONENTS

All NINZ panic exit devices come in complete kits to ensure **CE** product certification in conformity with regulation EN 1125:2008.

The following examples serve to help understand what a panic exit device is composed of in order to conform to the certified sample.

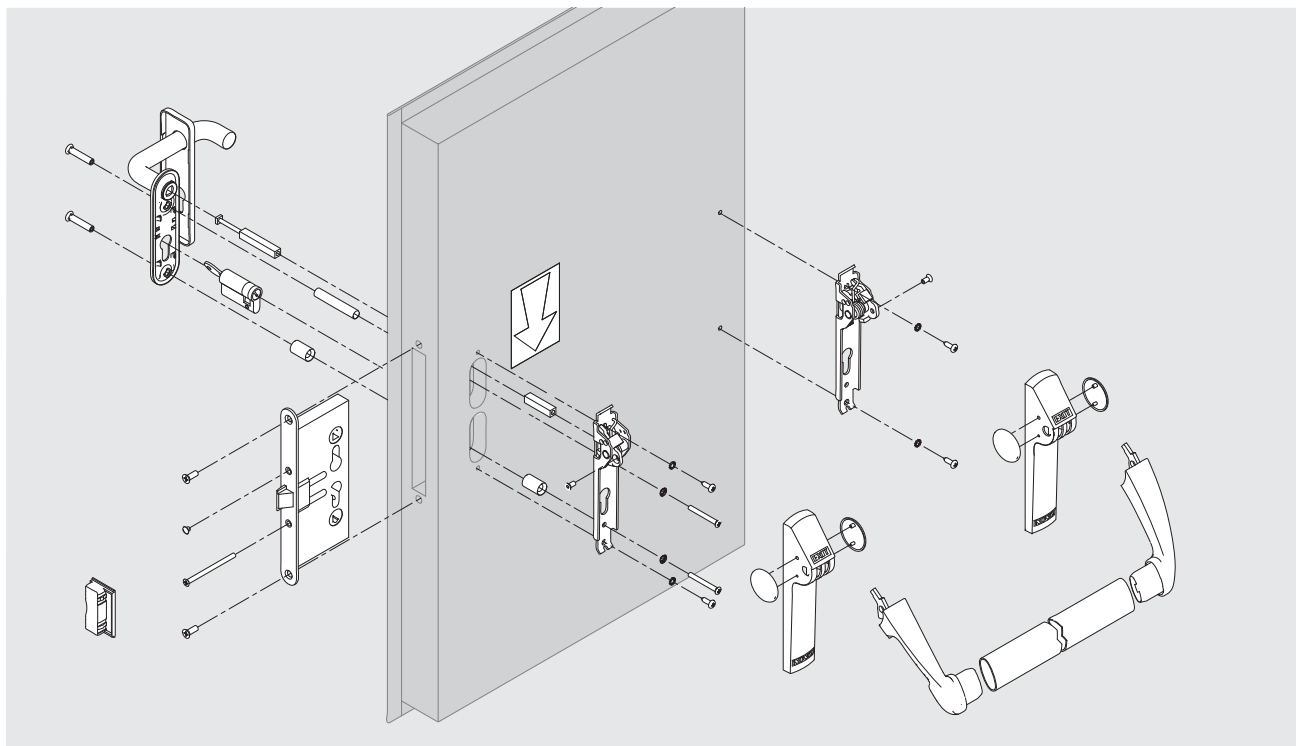

Components of the EXUS system for single-leaf doors

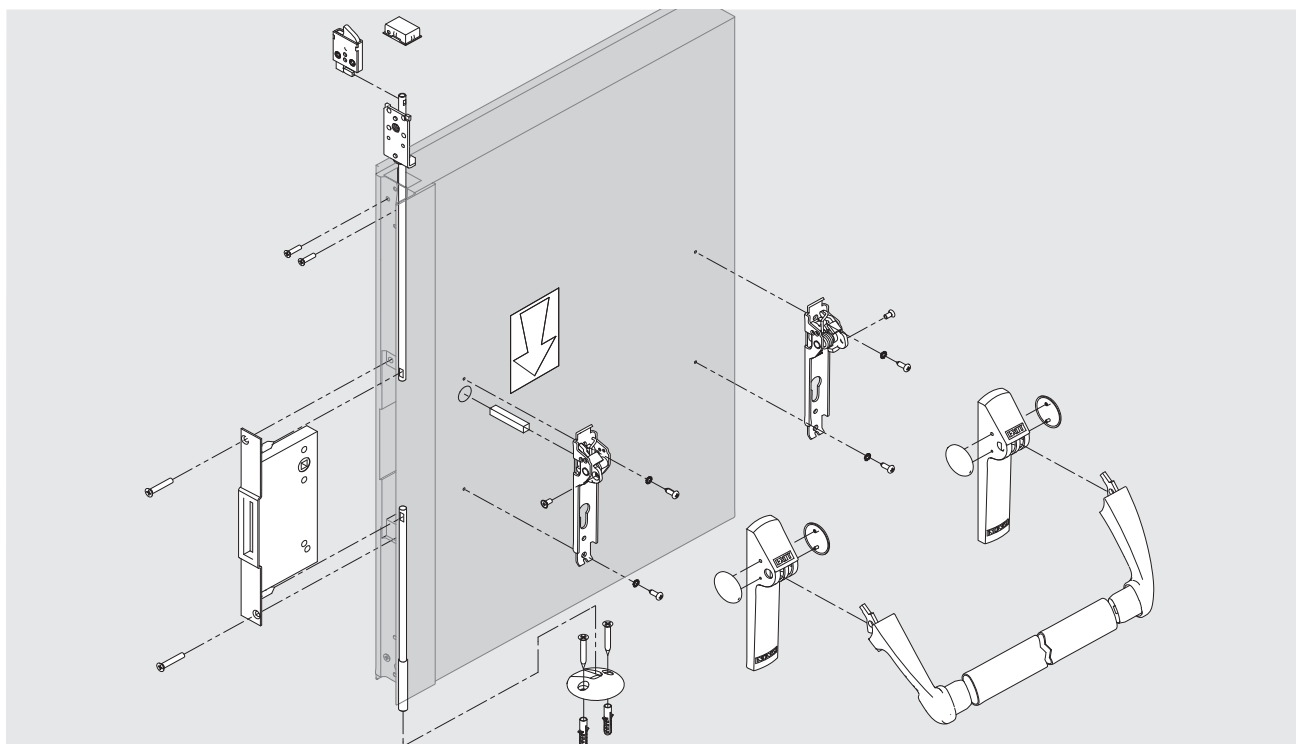

Components of the EXUS system for the passive leaf of double-leaf doors

Optional variations

For panic exit devices

STAINLESS STEEL EXTERNAL CONTROLS

All of the black nylon KITs (except those for glazed doors) can be provided with polished stainless steel external BM and BSP controls.



BM polished stainless steel

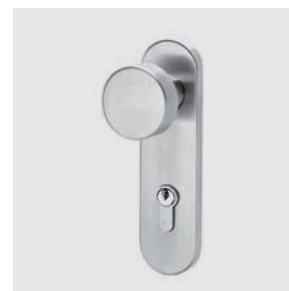

BSP polished stainless steel

COLORED PLASTIC EXTERNAL CONTROLS

All of the black nylon KITs (except those for glazed doors) can be provided with painted PP polypropylene external BM and BSP controls.

Colori disponibili:

RAL	RAL	RAL	RAL	RAL	
1023	7016	7035	9006*	9010	*light aluminium

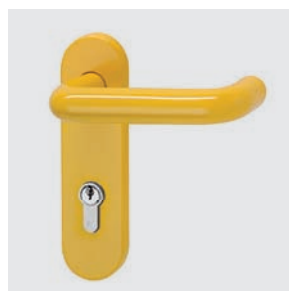

BMC colored RAL1023

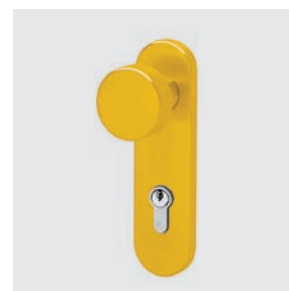

BSPC colored RAL1023

PAINTED HORIZONTAL BAR

All KITs (except those with stainless steel bars) can be provided with an aluminum horizontal bar painted in the requested RAL color.

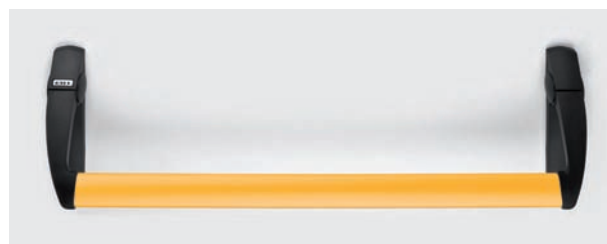

VERSION "E" WITH MICROSWITCH

All KITs can be provided with a microswitch incorporated in the hinge-side of the mechanism for indicating when the door is open. The cable and cable gland for the electrical connection between the panic bar and the wall are included.



"MAC® 1" ACCESS CONTROL SYSTEM

All KITs with type BM external commands (except those for glazed doors) can include a panic latch mechanism that also functions for access control. This option includes a MAC® 1 latch mechanism and an external control with an LED signal on the plate. The MAC® 1 latch mechanism is not reversible, it is necessary to indicate the opening direction of the door.

TECHNICAL SPECIFICATIONS

- Power supply 12-24 Vdc, 12-24 Vac
- Absorption 250 mA with peak at 500 mA
- Timer incorporated, fixed time of 30 seconds
- Possibility of continuous power source (stopped during daytime)



Black nylon handle with LED



Stainless steel handle with LED

Drawings of encumbrances

For panic exit device components

Article no.	Description
3201001.016	Latch mechanism for single-leaf door or active leaf (AP 16/18)
3201001.024	Safety lock for passive leaf (AP 020 P)
3201001.008	Safety lock for passive leaf UNIVER MULTI-PURPOSE and REVER (AP 020 U)
3201001.041	MAC® 1 SX (left-opening) latch mechanism
3201001.042	MAC® 1 DX (right-opening) latch mechanism
2401001.001	Lower bushing for passive leaf PROGET and MULTI-PURPOSE
3105019.001	Lower bushing for passive leaf UNIVER
3105020.001	Lower bushing for passive leaf REVER
2401006.001	Latch mechanism keeper insert for single-leaf door PROGET and MULTI-PURPOSE
3105080.001	Upper device for passive leaf PROGET and MULTI-PURPOSE
3105024.001	Upper device for passive leaf UNIVER and REVER
2401046.001	Upper keeper for passive leaf PROGET and MULTI-PURPOSE
3305001.001	Link arm guide for passive leaf

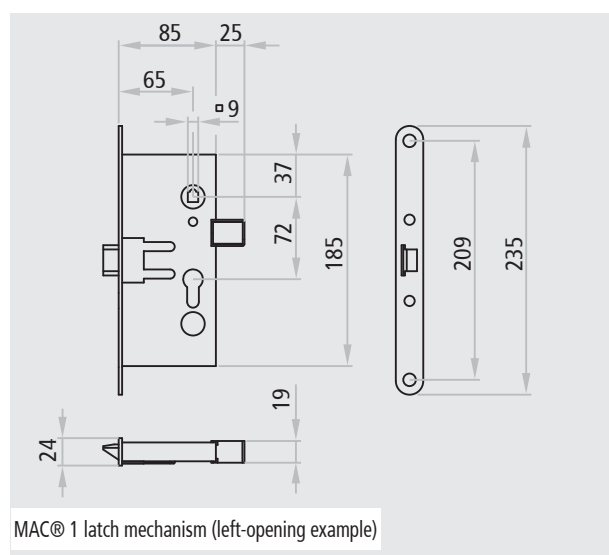
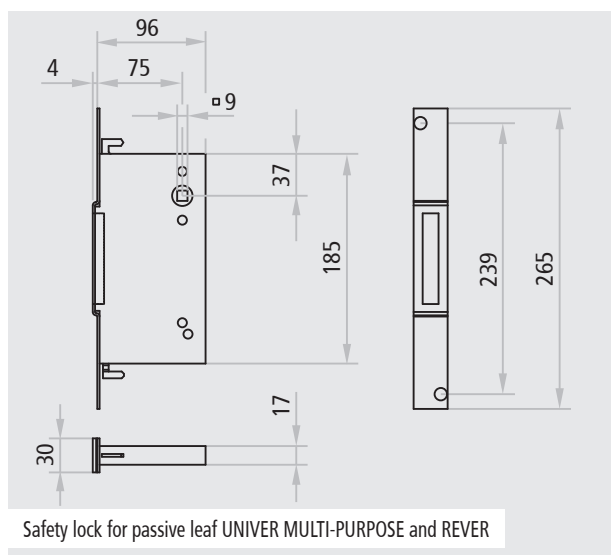
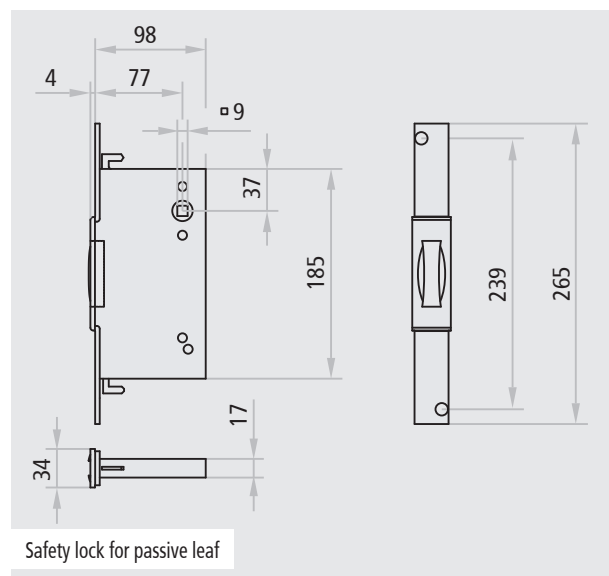
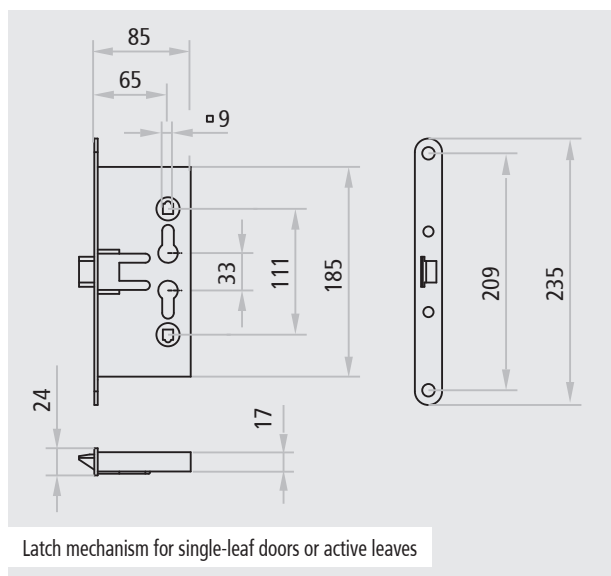

Drawings of encumbrances

For panic exit device component

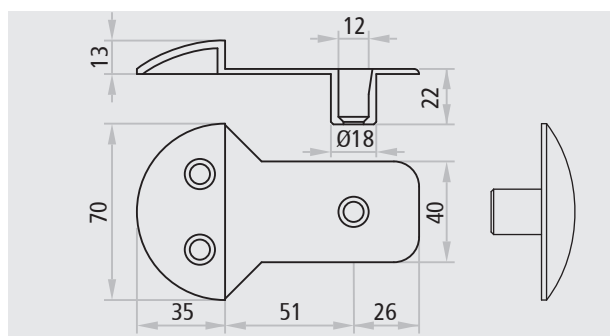

Lower bushing for passive leaf PROGET and MULTI-PURPOSE

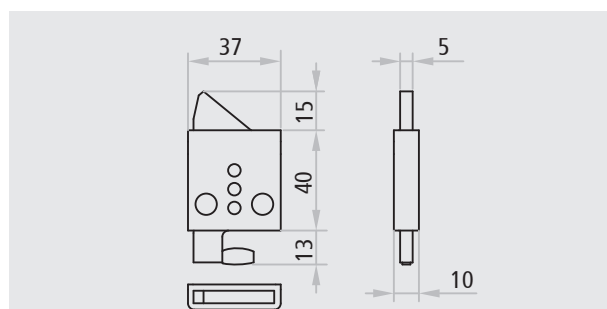

Upper mechanism for passive leaf PROGET and MULTI-PURPOSE

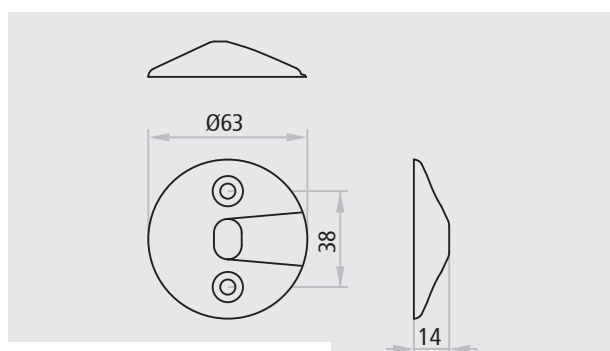

Lower bushing for passive leaf UNIVER

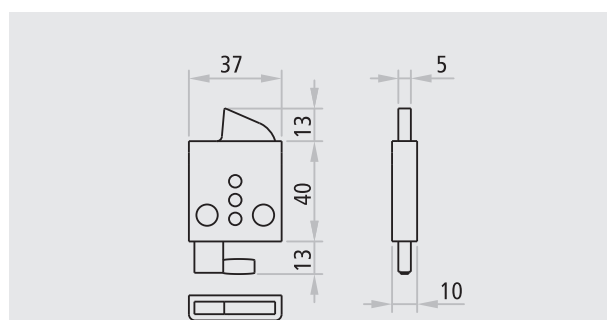

Upper device for passive leaf UNIVER and REVER

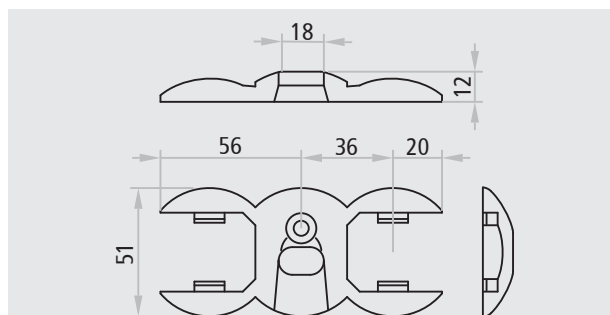

Lower bushing for passive leaf REVER

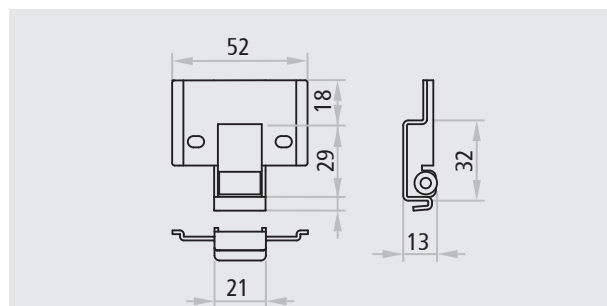

Upper keeper for passive leaf PROGET and MULTI-PURPOSE

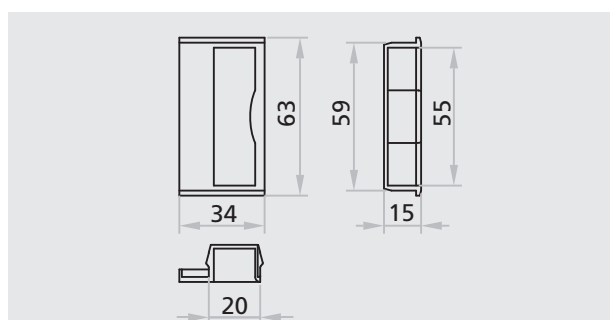

Latch mechanism keeper insert for single-leaf door PROGET and MULTI-PURPOSE

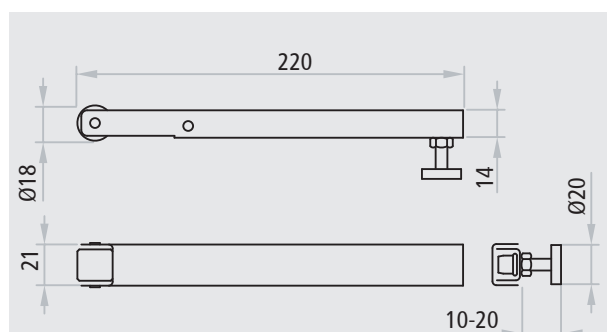

Link arm guide for passive leaf

Drawings of encumbrances, glazed doors

For panic exit device components

NINZ[®]
FIREDOORS

Article no.	Description
4506002.17	Latch mechanism for single-leaf or active leaf
4506002.18	Safety lock for passive leaf
4506006	Latch mechanism keeper plate for single-leaf door
3105000	Upper device and keeper for passive leaf
3105099	Lower bushing for passive leaf

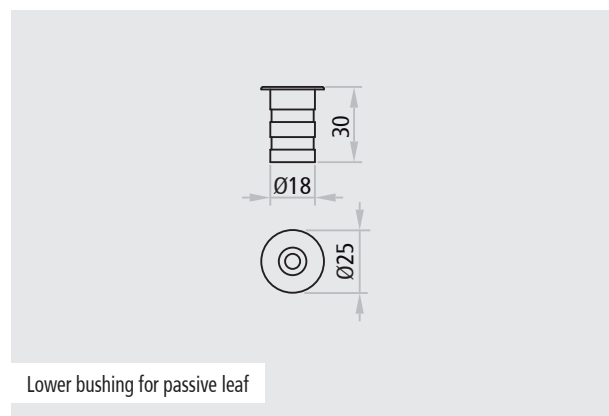
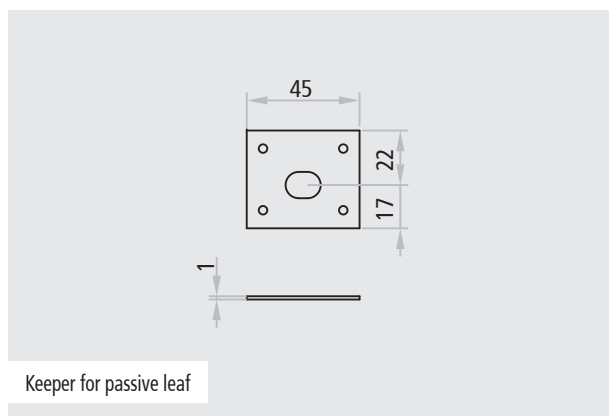
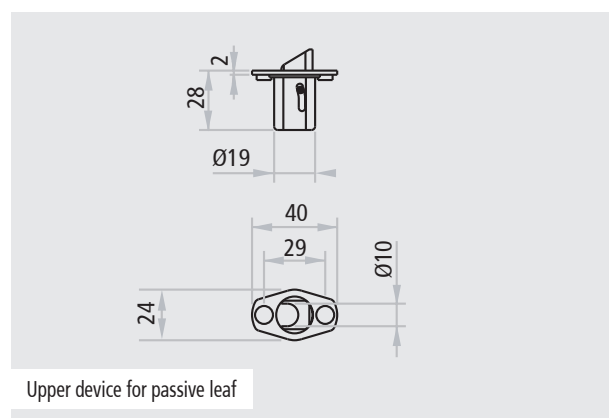
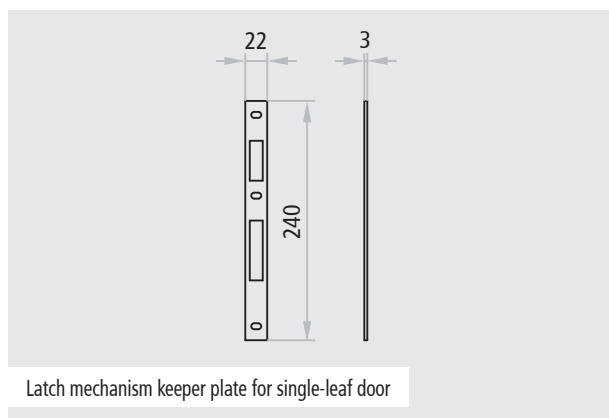
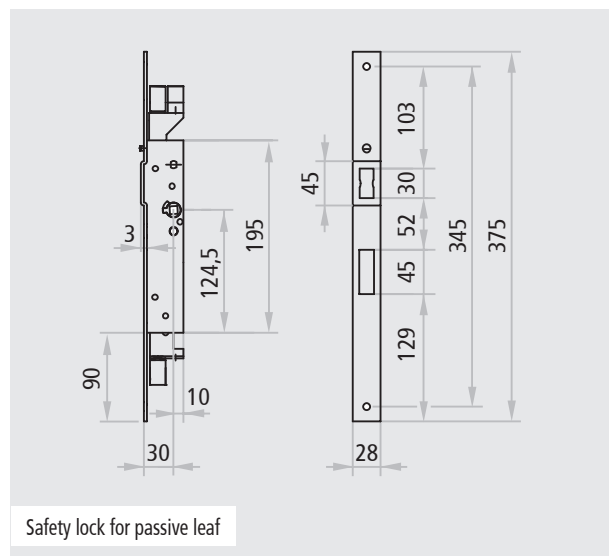
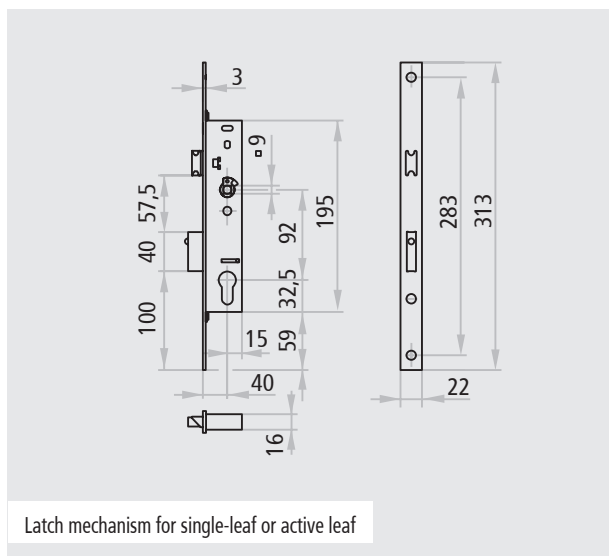

IMPORTANT INFORMATION

The safety features of panic exit devices are fundamental to their conformity with EN 1125:2008 because this regulation allows no modifications of any type, with the exception of those described in the manufacturer's installation instructions.

All NINZ® installation instructions for panic exit devices include a list of elements that have been tested and approved for use with the panic exit device and that can be packaged separately.

No modifications in the certified system are allowed and every component must remain unchanged.

Use of components other than those certified and contained in the package is not allowed.

All of the components supplied and described must be installed and assembled by qualified technicians in accordance with the installation instructions.

Panic exit devices manufactured in conformity with European regulations provide high levels of personal safety and adequate safety levels for material property as long as they are assembled on doors and doorframes that are in good condition.

Installation should be carried out by qualified personnel only, and in strict conformity with manufacturer instructions.

Once installation is complete, a dynamometer should be used to measure the force required for the horizontal bar to release the latch mechanism, and the forces that are measured should be entered in the maintenance record.

The instructions should be kept on file by the owner of the activity.

5002017/1 - C19

EDITION 01/2010

01.06.2010



Ninz S.p.A. | Corso Trento 2/A | I - 38061 Ala (TN)

Tel. +39 0464 678 300 | Fax +39 0464 679 025

info@ninz.it | www.ninz.it